

Conferences, Meetings & Events



THE
Blackwell Grange
HOTEL



Welcome to Blackwell Grange



Dawn Raine
General Manager



Victoria Taylor
Sales Manager



Nicola Dent
Meeting & Events
Manager

From a meeting of two, up to a conference of 250 delegates, Blackwell Grange Hotel has a full selection of spaces for you to meet, present, discuss and breakout. Spend the day with us or stay overnight after your meeting. We have all your needs covered including ample complimentary on-site vehicle parking.

Blackwell Grange Hotel is a stunning 17th Century mansion, which enjoys an enviable setting in the beautiful County Durham countryside. Nestled on its own grounds in wooded parkland on the outskirts of Darlington and located between the North Yorkshire Moors and the Pennines, yet only forty-five minutes from the historic cities of York and Newcastle.

Blackwell Grange Hotel provides a sanctuary to host your conference or meetings and we look forward to seeing you soon.

Email

Dawn: gm.blackwell@bruhennyhotels.co.uk

Victoria: sales.blackwell@bruhennyhotels.co.uk

Nicola: events.blackwell@bruhennyhotels.co.uk



Suites & Meeting Rooms



Bruhenny Suite

The Bruhenny Suite is a bright, airy room flooded with natural daylight. A staircase within the room leads you to the *Bruhenny Bar* on a mezzanine level. This magnificent suite can accommodate up to 250 delegates in a theatre style seating arrangement. The Bruhenny Suite may also be broken into two separate rooms – *Lime* and *Lilac* – for smaller groups.

George Allan Suite

Conference organisers may also choose from the George Allan Suite with its traditional décor looking over the south terrace and grounds with direct access to the gardens. The George Allan Suite has lots of natural daylight with multiple large floor to ceiling Georgian windows. This suite room will seat up to 80 delegates in a theatre style arrangement. For smaller groups the George Allan Suite may be broken into two separate rooms – *Grange* and *George* – both offering all the benefits of the suite on a smaller scale.

Library, Drawing Room & Study

Located on the first floor of the main building these rooms are ideal for boardroom meetings and interviews. They will typically accommodate eight to ten delegates in a boardroom table layout.



Suites & Rooms – Dimensions & Capacity



	Level	Floor Area	Ceiling Height	Door WxH	Theatre	Board	U	Class	Cab	Rec	Dinner	Dinner Dance	Air Con	Natural Daylight
Bruhenny Suite	G	14.2 x 17m	4/2.4m	1.72 x 2.2m	250	n/a	40	100	84	250	180	150	Yes	Yes
Lilac Room	G	7.8 x 14.5m	2.4m	1.72 x 2.2m	140	40	40	40	36	80	60	–	Yes	No
Lime Room	G	6.4 x 17.8m	4m	1 x 2.18m	110	25	30	40	30	100	60	40	Yes	Yes
George Allan Suite	G	14.1 x 10m	4.3m	1 x 2.18m	80	30	32	40	50	100	80	70	No	Yes
George Room	G	6.3 x 10.3m	4.3m	1 x 2.18m	60	30	30	30	30	40	50	40	No	Yes
Grange Room	G	7.8 x 5m	4.3m	1 x 2.18m	40	16	12	10	18	40	30	–	No	Yes
Harrogate Room	1	6.9 x 13.3m	2.5m	0.81 x 2m	70	30	30	40	30	n/a	n/a	–	No	Yes
Library	1	5 x 4.6m	3.5m	0.96 x 2.25m	–	10	–	–	–	–	8	–	No	Yes
Study	1	5.1 x 3.8m	3.5m	0.96 x 2.25m	–	8	–	–	–	–	8	–	No	Yes
Drawing Room	1	5.2 x 4m	3.5m	0.78 x 2.25m	–	10	–	–	–	–	8	–	No	Yes

U = Horseshoe / U Style Class = Classroom Style Cab = Cabaret Rec = Round & small cocktail tables



Room Hire & Delegate Rates

<i>Suite</i>	<i>Full Day £</i>	<i>Half Day £</i>
Bruhenny Suite	750	400
Lilac Room	400	250
Lime Room	500	250
George Allan Suite	400	250
George Room	300	200
Grange Room	200	100
Harrogate Room	200	100
Library	125	95
Study	125	95
Drawing Room	125	95

Refreshments included in your day delegate rate can either be a chef's choice on the day or you can choose one option from the following per break:

- ◆ Freshly baked Danish pastry
- ◆ Selection of fresh fruit
- ◆ Selection of muffins
- ◆ Cereal Bars
- ◆ Chocolate chip cookies
- ◆ Biscuits

* All rates include VAT and correct at April 2018

Day Delegate Rates from £32.00

To include, hire of the main meeting room, three servings of tea and coffee with your choice of snack. Lunch of your choice based on your delegate numbers. Bottled water and boiled sweets. Selection of conference stationery, screen, flipchart and LCD projector

Half-Day Delegate Rate from £22.00

To include, hire of main meeting room (8.00-13.00/13.00-18.00), one serving of tea and coffee with your choice of snack on arrival and working lunch. Bottled water and boiled sweets. Selection of conference stationery, screen, flipchart and LCD projector

24 Hour rate from £125.00

To include, all of the above, plus overnight accommodation and a two course evening meal in our restaurant and breakfast the following morning.

Please note for our **Working Lunch** options there is a minimum of eight delegates required and the meal is served to individual meeting rooms. Our Chef will present a daily selection from the following options (one from each line):

- | | |
|--|--|
| ◆ Variety of savoury fillings, presented in either bloomer bread, tortilla wraps, bagels, ciabatta or focaccia | ◆ Crisps/nachos/pickles/nuts |
| ◆ Fries/hand cut chips/sweet potato fries/seasoned wedges | ◆ Selection of sauces/dips |
| ◆ Individual quiche/mini pork pie/sausage rolls/mozzarella melts | ◆ Mixed salad & coleslaw |
| | ◆ Chef's selection of bite size desserts |
| | ◆ Fresh fruit platter |
| | ◆ Freshly brewed tea & coffee |



Buffet Menu Options

Fork Buffet Option – Monday

Mexican Chilli
Vegetable Lasagne
Rice, Taco shells & tortillas
Mixed Leaf salad
Crunchy Coleslaw
Chef's choice of mini desserts
Fresh whole fruit basket
Freshly brewed tea & coffee

Fork Buffet Option – Tuesday

Italian Style Lasagne
Sweet potato, chickpea & spinach curry,
rice, naan & poppadum
Spicy Potato Wedges
Garlic Bread
Mixed leaf salad
Chef's choice of mini desserts
Fresh whole fruit basket
Freshly brewed tea & coffee

Fork Buffet Option – Wednesday

Beef Bourguignon
Mushroom Stroganoff
Rice
Panache of seasonal vegetables
Sea salt & rosemary roasted new potatoes
Chef's choice of mini desserts
Fresh whole fruit basket
Freshly brewed tea & coffee

Fork Buffet Option – Thursday

Hot Carvery Sandwiches – Beef or Pork
Roasted pepper, red onion, pesto,
mozzarella paninis
(Vegetarian option available on request)
Stuffing, apple sauce & gravy
Sea salt & rosemary roasted new potatoes
Chef's choice of mini desserts
Fresh whole fruit basket
Freshly brewed tea & coffee

Fork Buffet Option – Friday

Chicken in creamy white wine
and leek sauce
Tomato, basil & vegetable penne pasta,
garlic & herb slice
Hot buttered new potatoes
Panache of seasonal vegetables
Chef's choice of mini desserts
Fresh whole fruit basket
Freshly brewed tea & coffee

Please note for all fork buffet options there is a minimum number of eight delegates. (Served within the Havelock Restaurant)



Individual Refreshment Costs

Two course hot & cold, fork buffet lunch with tea & coffee served in the restaurant (if not on a delegate package)	£14.95
Two course working lunch with tea & coffee served to your meeting room (if not on a delegate package)	£13.95
Tea, coffee	£2.50
Tea, coffee & biscuits	£2.75
Tea, coffee & chocolate chip cookies	£3.50
Tea, coffee & Danish pastries	£3.95
Tea, coffee & fresh fruit	£4.25
Tea, coffee & muffins	£3.95
Tea, coffee & cereal bars	£3.95
Tea, coffee & bacon/sausage sandwiches	£5.95
Selection of sandwiches with crisps, salad & coleslaw, tea & coffee	£7.95
Selection of sandwiches with chips/fries, salad & coleslaw, fresh fruit, tea & coffee	£9.95
Selection of sandwiches with a serving of our soup of the day, tea & coffee	£9.95
Afternoon tea	£12.95

* All prices include VAT and correct at April 2018





Function Rooms

Bruhenny Suite

Lime Room

Lilac Room

George Allan Suite

Grange Room

George Room

Havelock Suite

Bars

Blackwell Bar

Miss Allan Bar

Havelock Bar

Bruhenny Bar

State Rooms

239 - 252

West Wing

Ground: 125 - 138

1st Floor: 225 - 238

2nd Floor: 325 - 338

North Wing

Ground: 110 - 124

1st Floor: 210 - 224

2nd Floor: 310 - 324

Havelock Square

601 - 611

Meeting Rooms

242, 244 (Library), 249

Harrogate Room

(over Leisure Centre)

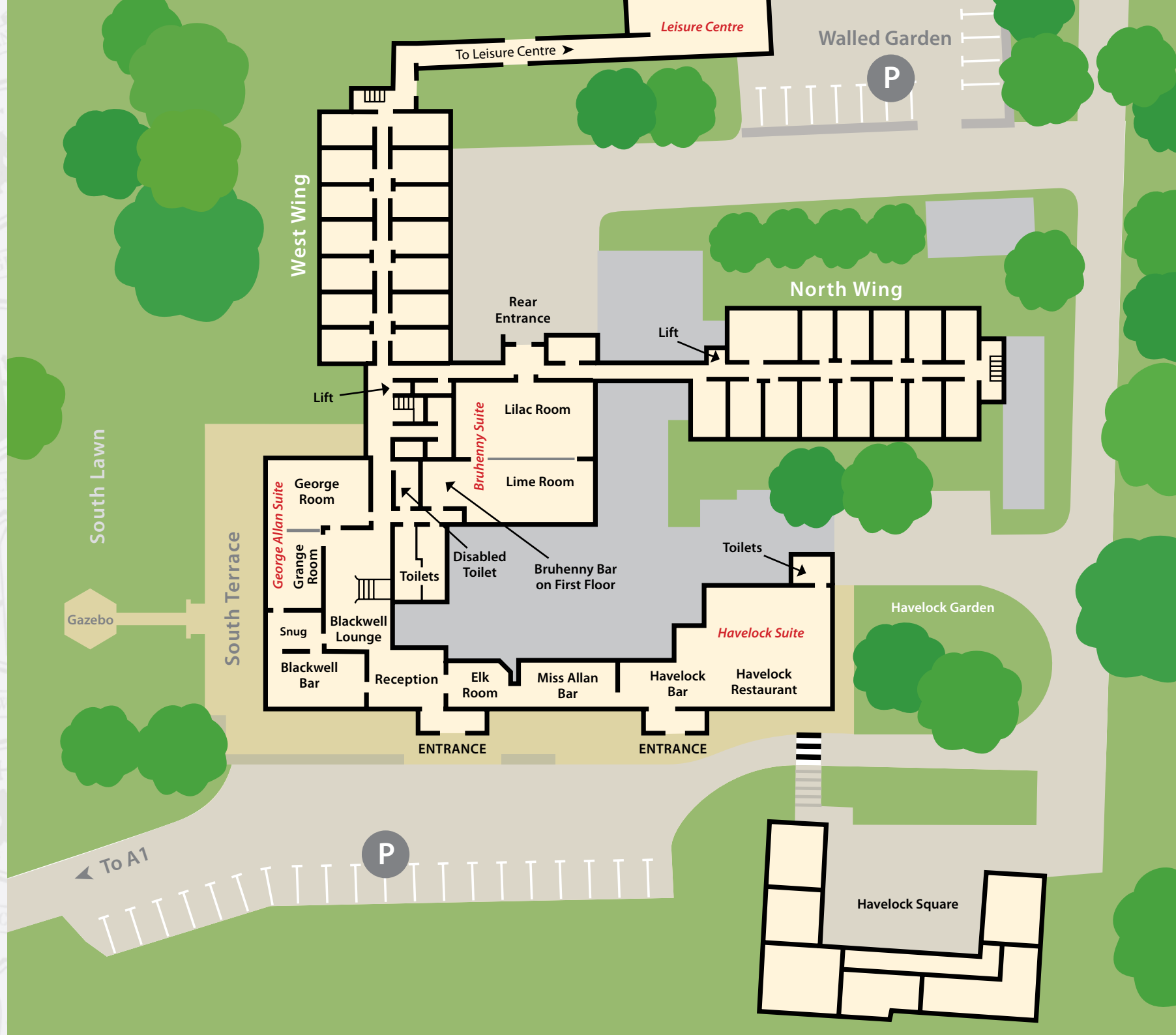



How to find us

From A1 South – at Junction 57 take the A66M signposted Darlington. At the second roundabout take the second exit onto the A167. The Hotel is 500 yards on the left.

From A1 North – at Junction 58 take the A167 towards Darlington. We are situated on the A167 about 1.5 miles from the central ring road.

Nearest Train Station – Darlington 1 mile

Nearest Airports – Durham Tees Valley 6 miles

Newcastle International 44 miles / 55 Minutes

Contact Us

To book your meeting or event with us
events.blackwell@bruhennyhotels.co.uk
sales.blackwell@bruhennyhotels.co.uk

To book your overnight stay with us
reservations.blackwell@bruhennyhotels.co.uk



THE
Blackwell Grange
HOTEL

Grange Road · Darlington · County Durham DL3 8QH

T: +44 (0) 330 102 7238